



OUR STORY

In 1998, Scooter's Coffee was born. Co-founders Don and Linda Eckles began an amazing journey when they opened their first drive-thru coffeehouse in Bellevue, Nebraska. Their keys to success: find a great location and stay committed to high-quality drinks, speed of service, and a BIG smile.

Scooter's Coffee's success over many years of history is very simple: stay committed to the original business principles and company core values. The Scooter's Coffee Brand Promise, spoken of often to franchisees, customers and employees is: "Amazing People, Amazing Drinks... Amazingly Fast!®" It represents the company's business origins from 1998 and reflects a steady commitment to providing an amazing experience for our customers.



BE AMAZING!



OWNASCOOTERS.COM
877.494.7004



REAL ESTATE SITE CRITERIA & SITE SELECTION

OWNASCOOTERS.COM



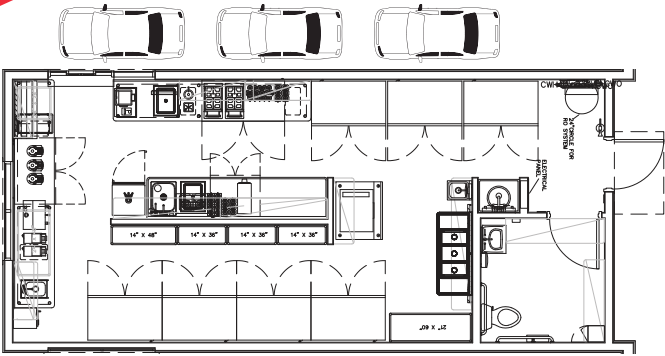

- BUILDING: 630 sq ft
- LOT SIZE: 5,000 sq ft
- PARKING: 4 employee parking fields
- WATER & SEWER: Required
- VOICE & DATA: Required
- GAS: Not required
- GREASE TRAP: Per city codes
- DRIVE-THRU LANE: Stacking must meet city codes
- WALK-UP WINDOW: Optional
- PATIO: Optional
- SIGNAGE: Maximum allowed by city/landlord

AWARDS



SITE PLAN

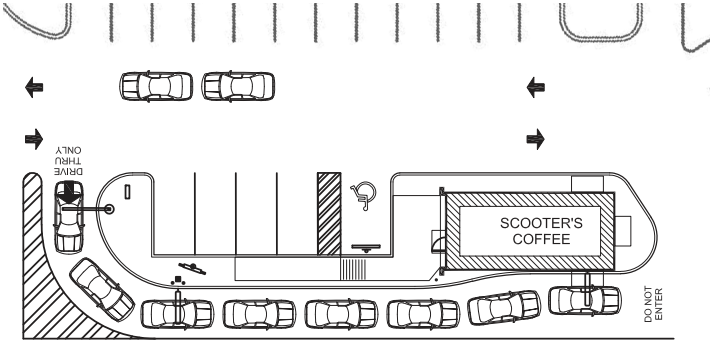

NATIONAL EXPANSION

Opened 48 STORES in 2020
On track to open 140 STORES in 2021



- Available Markets (open for development)
- States with Open Locations or Commitments
- Sold Out Markets

LOCATION CRITERIA

- 25,000+ Vehicles Per Day
- Hard corner preferred
- Stop light preferred
- Popular morning commute routes
- Morning commute side of the street
- Parking fields or small parcels (5,000+ SF)
- In your face visibility
- Access from all directions (no medians)
- Speed limit 25-45 mph
- Plentiful signage opportunities
- Ground Lease or Sale

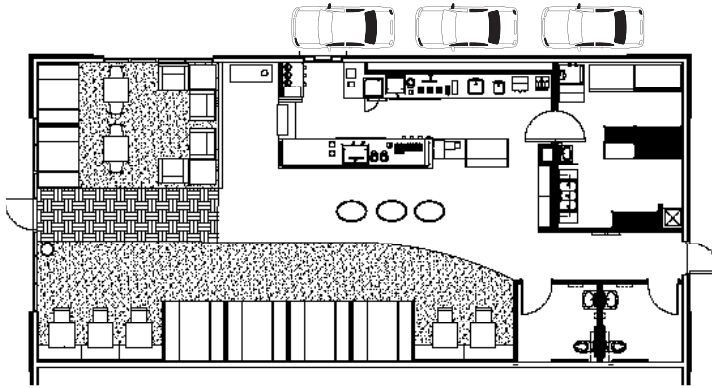

- BUILDING: 1,600 - 2,000 sq ft
- PARKING: Per city requirement
- HVAC: 7.5 tons
- ELECTRIC: 400 amps, 3 phase
- WATER & SEWER: Required
- VOICE & DATA: Required
- GAS: Not required
- GREASE TRAP: Not required
- ORDER BOX: 1 (required)
- DRIVE-THRU WINDOW: 1 (required)
- DRIVE-THRU LANE: Stacking must meet city codes
- PATIO: Preferred
- SIGNAGE: Maximum allowed by city/landlord
- LOCATION: End cap of a strip center (drive-thru window required)